



43 Pacific Drive Swansea Heads NSW

4 3 3

Situated in a prime location on Pacific Drive and designed for seamless, contemporary living sits the striking result of a meticulous, high-end architectural build.

Defined by luxurious appointments this striking architectural design focuses on relaxed entertaining spaces, indoor/outdoor living zones, and an instinctive family floorplan.

Combined with the use of heart-warming cedar accents and the extensive use of glass, louvres and balconies to enhance natural light, sea breezes, ocean views and the spectacular sunrises, this stunning family haven promotes the ultimate Swansea Heads lifestyle.

Less than a 25m walk delivers you onto the sand and into

Land Size : 727 sqm
View : <https://www.3realty.com.au/sale/nsw/lake-macquarie-east/swansea-heads/residential/home/6008604>



Joel De Shannon
1300 848 332



Tina Bone
1300 848 332



Site Plan
Not to Scale

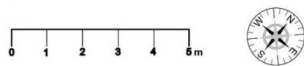
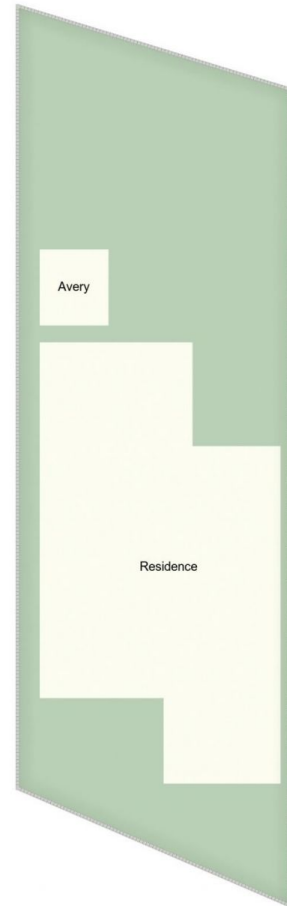

43 Pacific Dr, Swansea Heads

All information contained herein is gathered from sources we deem reliable. However, we cannot guarantee its accuracy and act as a messenger only in passing on the details. Interested parties should rely on their own inquiries and the contract for sale. The floor plans are artist's impressions only. The site plan is not to scale.

