





68 Kullaroo Road Summerland Point NSW

3  1  2 

From the moment you enter the foyer you will be greeted with feelings of space and modern day living environments freshly renovated for immediate occupation.

Newly installed flooring, freshly painted interiors and soothing lake views will entice your eyes, whilst the quietness of the street and proximity to the lake will remind you that you are in a peaceful and rejuvenating location.

Newly tiled 3-way bathroom, separate bath and dual shower as well as his and hers vanity complete with new tapware will confirm that this spacious home delivers feelings of comfort in every room.

Open plan kitchen strategically positioned to engage the large family room and spacious enclosed pergola will be

Price : \$ 590,000

Land Size : 594 sqm

View : <https://www.3realty.com.au/sale/nsw/central-coast-region/summerland-point/residential/house/6008525>



GROUND LEVEL

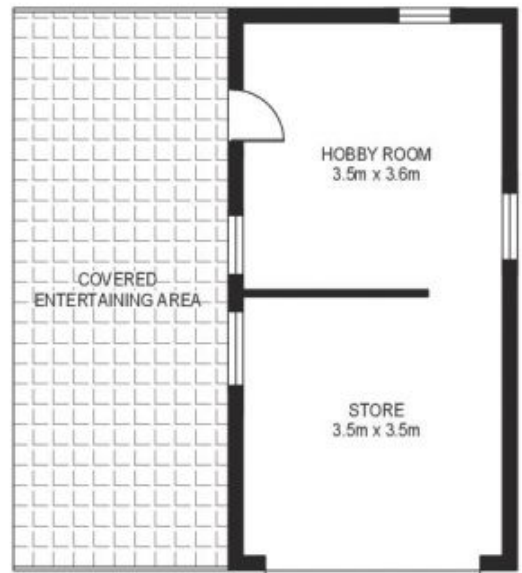

GROUND LEVEL

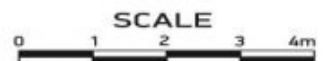

3REALTY

68 KULLAROO ROAD,
SUMMERLAND POINT



Internal Area: 172m²
External Area: 40m²
Total: 212m²

DISCLAIMER: Measurements are approximate

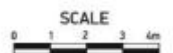

3REALTY

68 KULLAROO ROAD,
SUMMERLAND POINT



Internal Area: 172m²
External Area: 40m²
Total: 212m²

DISCLAIMER: Measurements are approximate